

M-2-ECO, M-3-ECO, M-5-ECO

. K06808

. K06810

. K06812

/

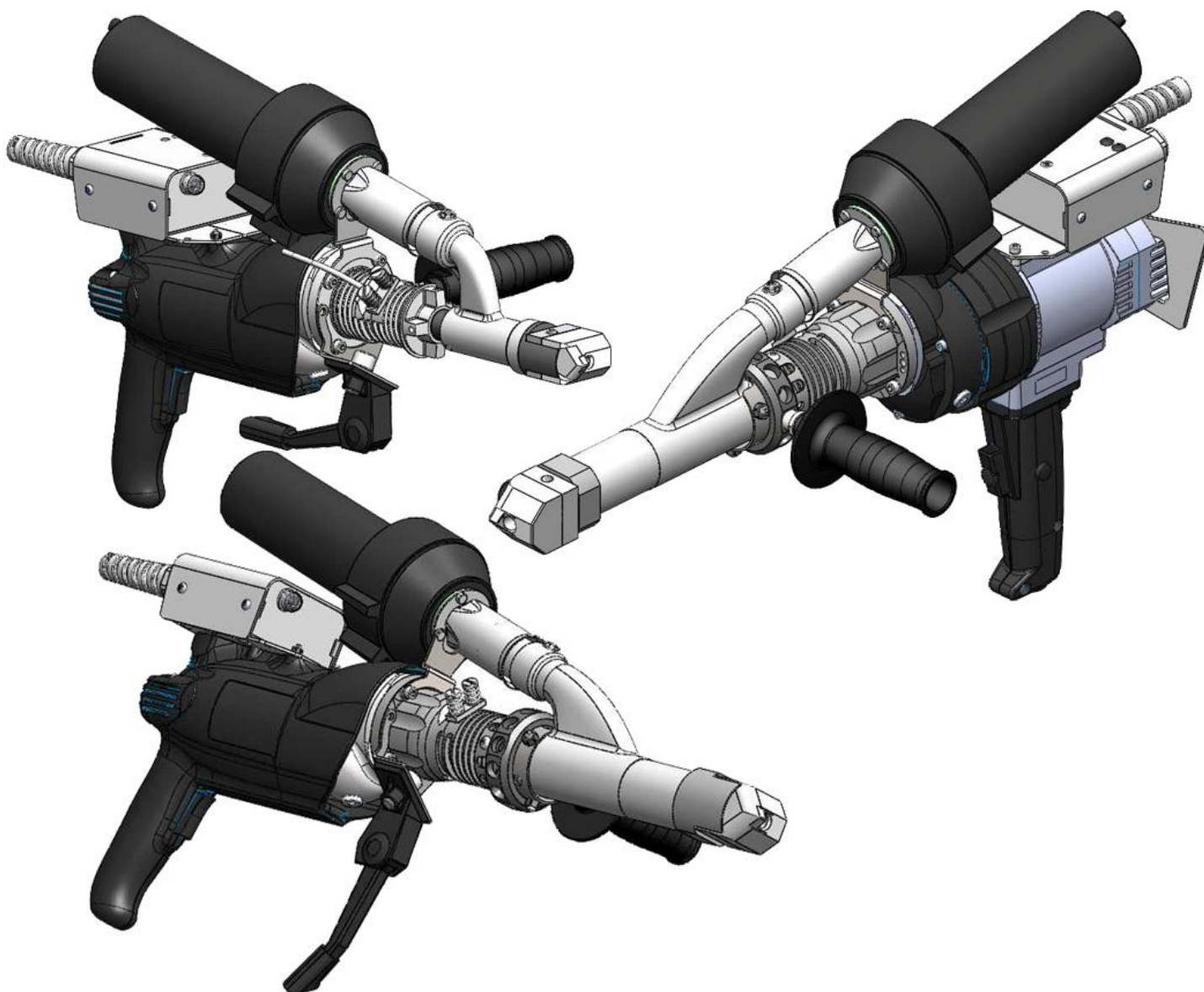

MUNSCH Kunststoff-Schweißtechnik GmbH
Im Staudchen • D-56235 Ransbach-Baumbach, Germany
Phone: +49 (0) 26 23-8 98-0
Fax: +49 (0) 26 23-8 98-21
Internet: <http://www.munsch.de>



« - »
115201 . , . , 7/8
./ : +7 495 150-0822
Internet: <http://www.adr-t.ru>
E-mail: info@adr-t.ru

1	4
1.1	4
1.2	4
1.3	5
1.4	5
2	5
2.1	5
2.2	6
2.2.1	6
2.2.2	6
3	7
3.1	7
3.2	9
3.3	9
3.4	9
4	10
4.1	10
4.2	10
4.3	11
4.3.1	11
4.3.2	11
4.3.3	11
4.3.4	11
5	—	12
6	12
7	13

Konformitätserklärung des Herstellers
im Sinne der EG-Maschinenrichtlinie 98/37/EG Anhang II B,



EU machinery directive 98/37/EEC, Annex II B

MUNSCH Kunststoff-Schweißtechnik GmbH
Im Staudchen
D-56235 Ransbach-Baumbach

Produktbezeichnung: M-2-ECO, M-3-ECO, M-5-ECO

EC Machinery Directive.

():

- ✓ DIN EN ISO 12100: 2010
- ✓ DIN EN 13732-1: 2008

EC-Produktbezeichnung: M-2-ECO, M-3-ECO, M-5-ECO

- | | |
|--|------------------------------|
| ✓ EU Low-Voltage Directive 73/23/EC | ✓ EU EMC Directive 89/336/EC |
| ✓ EN 60204-1 (VDE 0113 Part 1): 2011 | ✓ DIN EN 55014-1: 2012 |
| ✓ EN 61029-1 (VDE 0740 Part 500): 2010 | ✓ DIN EN 55014-2: 2009 |
| ✓ VDE 0701 Part 1: 2008 | |
| ✓ RoHs 2011/65/EU | |

Dipl.-Ing. Stefan Munsch,

Ransbach-Baumbach, 22.09.2015

1

1.1

M-2-ECO, M-3-ECO, M-5-ECO

1.2

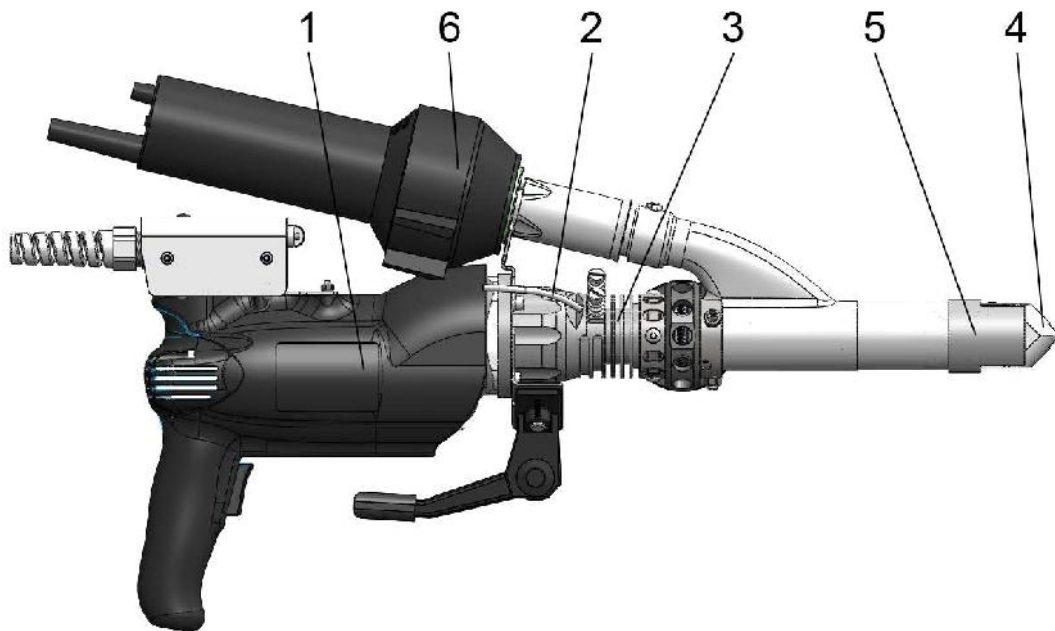

1.

2.

M-2-ECO, (M-3-ECO, M-5-ECO)
Ø4 Ø5

Ø3 Ø4

M-5-ECO

3.

4.

-4,

5.

M-2-ECO, M-3-ECO, M-5-ECO
360°

6.

1.3

(50-70°)

- M-2-ECO M-3-ECO Ø3 Ø4
- M-5-ECO Ø4 Ø5
- M-5-ECO

1.4

	M-2-ECO	M-3-ECO	M-5-ECO
	Ø3	Ø4	Ø4 Ø5
	Ø3 - 1,1 Ø4 - 1,8	Ø3 - 1,8 Ø4 - 3,2	Ø4 - 3,0 Ø5 - 4,6
	4-15 1	8-30 1	15-40 1
	220-230 ± 5%, 50-60		
	1000	1000	1800
		1500	50-100%
	4,8	7,5	9,8

2

2.1

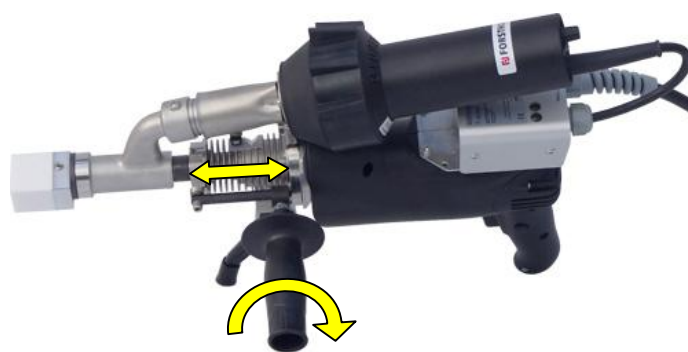

(4).
(25),
360°.
(25).

DVS 2207

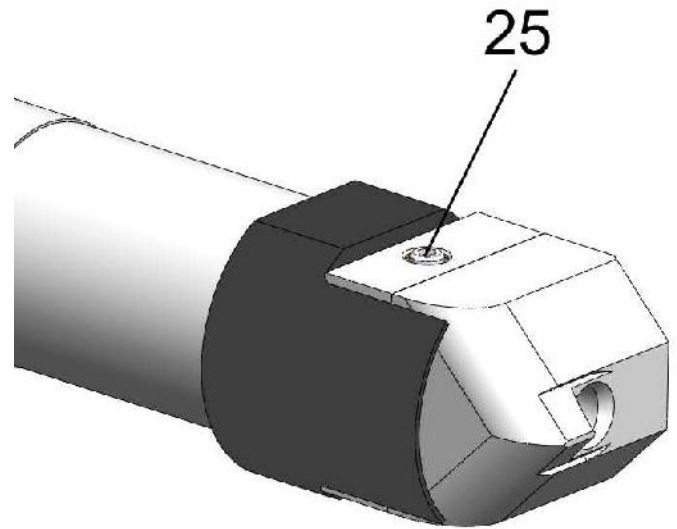

2.2



M-2-ECO, M-3-ECO, M-5-ECO

±5%.

220-230 , 50-60



2.2.1

•	19	M-2-ECO	M-3-ECO	:
•	20-50	2,5 ² .		
		4,0 ² .		
•	19	M-5-ECO		:
•	20-50	4,0 ² .		
		6,0 ² .		

2.2.2

•

•

•

•

•

3

3.1

██████████

(I)

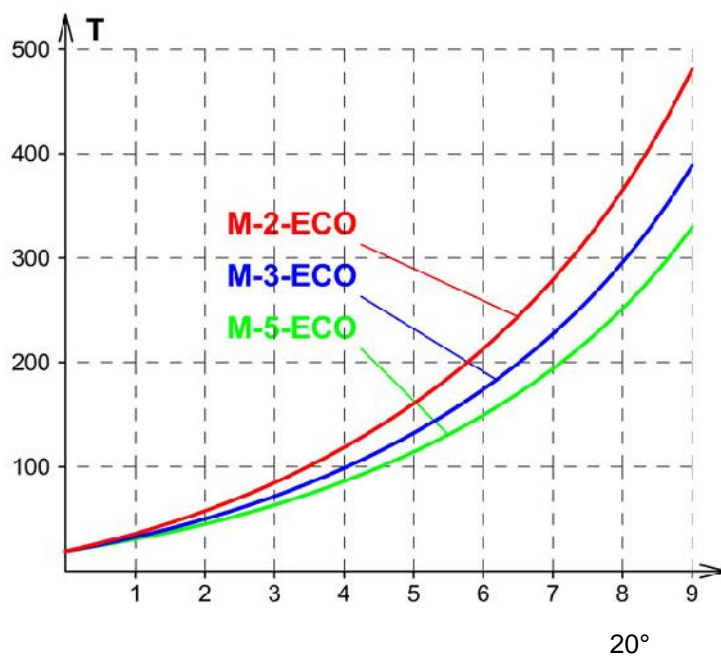
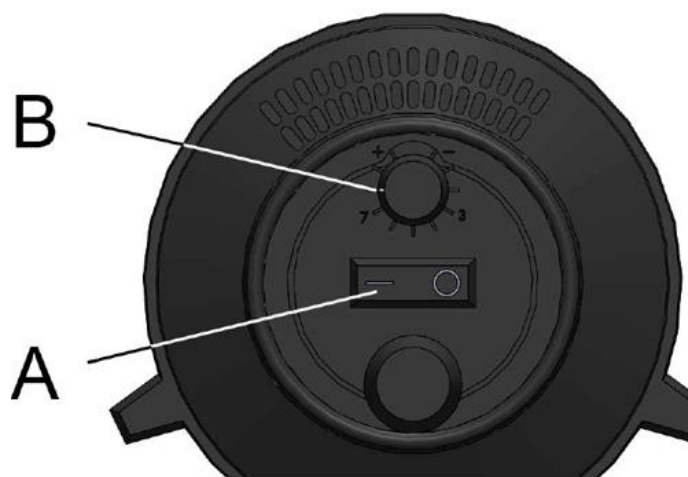

██████████

	200-240°	250-300°
	200-240°	250-300°
	240-260°	280-350°

10-15

██████████

-4 ()

260°

██████████

360°

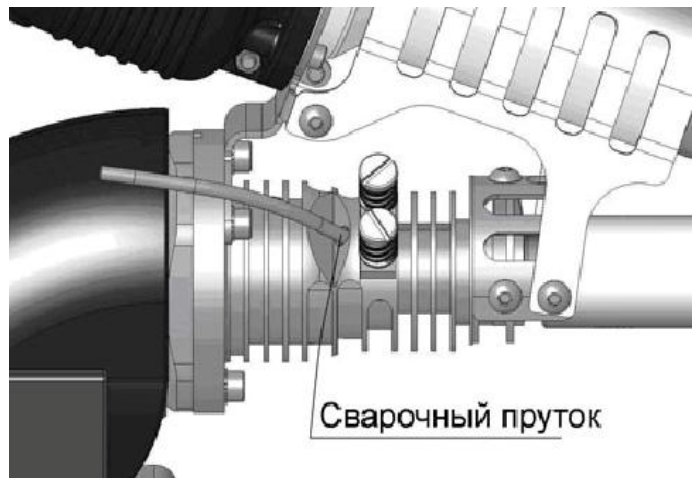

3.2

(20)



10

5-

« »

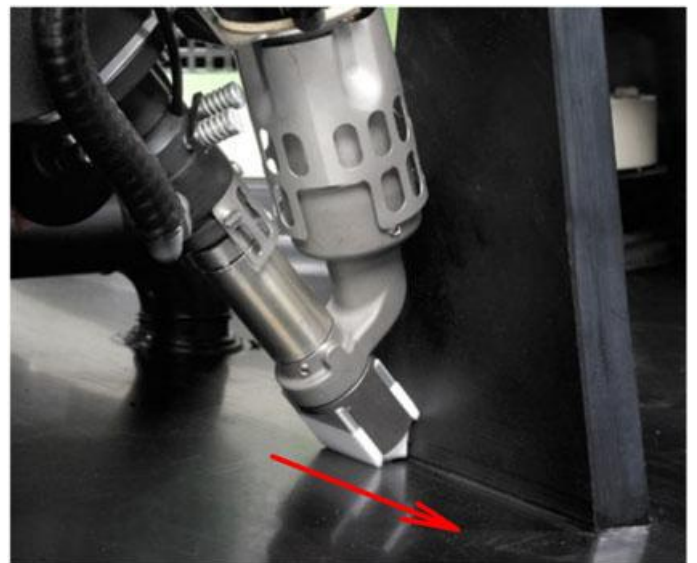

()

3.3

(15-20)

(. 3.4),

5

3.4

4

4.1

M-2-ECO, M-3-ECO, M-5-ECO

██████████ !
« ██████████ » 5-10
).
(. . 4.3.1).

██████████ !
██████████ :

4.2

M-2-ECO, M-3-ECO, M-5-ECO

1500), / - (

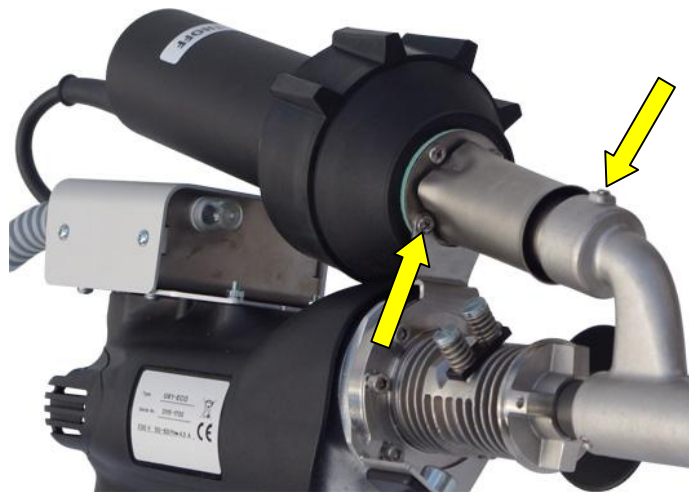

(15°)

15

MUNSCH

()

TUBE-Q

Forsthoff.

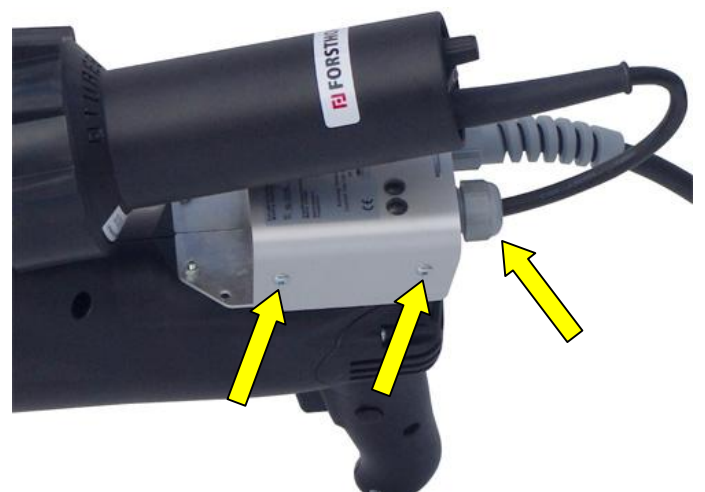

4.3

4.3.1

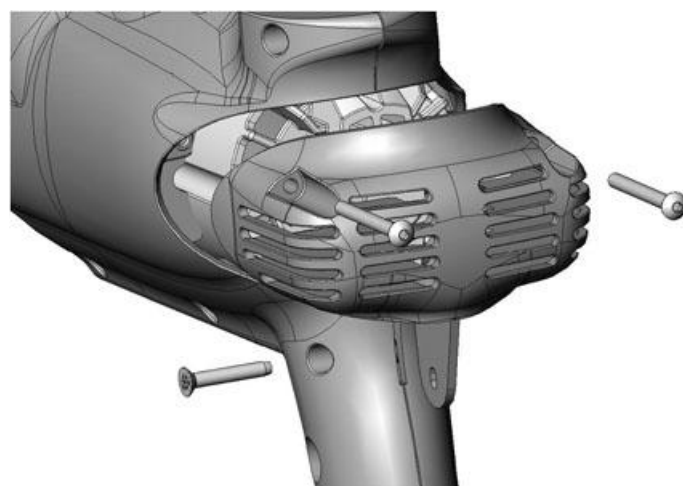

4.3.2

	M-2-ECO:	M-3-ECO, M-5-ECO:
—	K02669	K03701
—	K04361	K03702
—	K04362	K03703
—	K02965	K03704
—	K02698	K04080

4.3.3

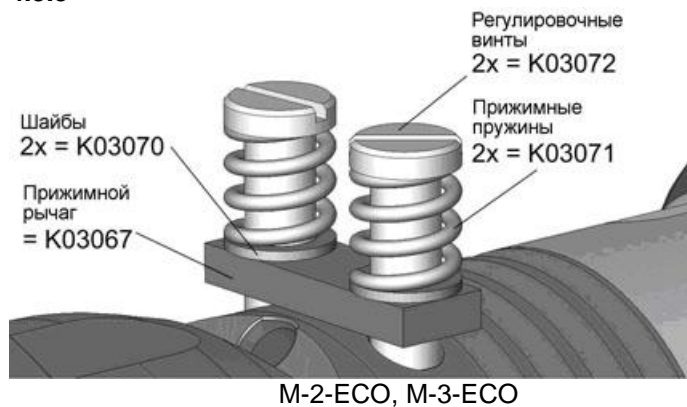

M-2-ECO, M-3-ECO

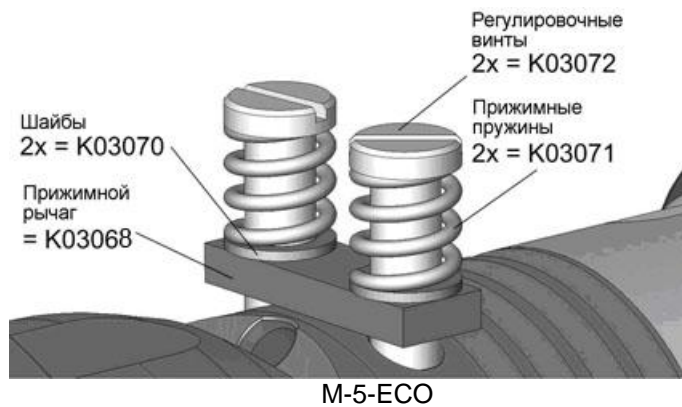

M-5-ECO

4.3.4

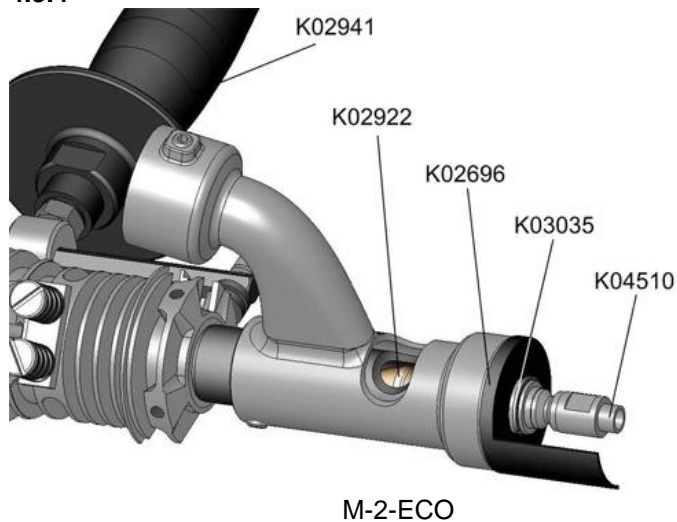

M-2-ECO

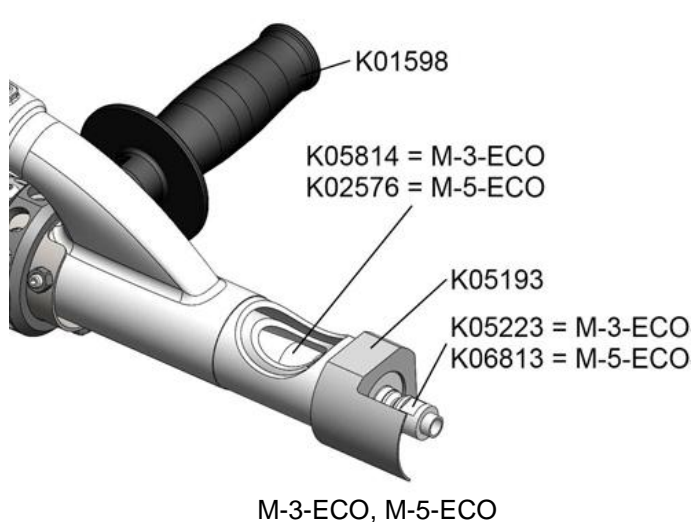

M-3-ECO, M-5-ECO

5

MUNSCH.

	5, 9, 11, 14, 15, 16, 17, 18, 23
	5, 9, 14, 15, 16, 17, 18, 23
	1, 16, 17, 20
	1, 16
	1, 14, 16
	13
	5, 22
	3, 5, 18, 22
	3, 22
	3, 18
	3, 13

1		
3		1)
5		
9		
11		
13		1)
14	-	
15		- ;
16		; !
17		1)
18		1)
20		« » « / »
22		1)
23		

1) MUNSCH

6

350°

(...).

2

- ;
- ;
- ;
- ;

7

1.		4.
2.	12	5.
3.		5.1.
3.1.		5.2.
3.2.		5.3.
	MUNSCH	5.4.
	MUNSCH.	5.5.
		5.6.
		5.7.
3.3.		6.
3.4.		7.
	6	
		.1.