

# TUBE-Quick



**FORSTHOFF**

Forsthoff GmbH  
D-42719 Solingen – Freiheistr.24  
Tel. +49-212-33-60-52  
Fax +49-212-33-69-16  
www.forsthoffwelding.com  
E-mail: info@forsthoffwelding.com

**ADR  
TECH**

«ADR TECH»  
Тел./факс: (495) 150-0822, 7/8  
www.adr-t.ru  
E-mail: info@adr-t.ru

# 1

# CE

Forsthoff GmbH  
D-42719 Solingen – Freiheistr.24  
DEUTSCHLAND

TUBE-Quick

EU Directive 2006/95/EU – NSR  
EU Directive 2004/108/EU – EMC

2006/95/EU

- EN 60335-1:2002 + A11:2004 + A1:2004 + A12:2006 + :2006 + A2:2006
- EN 60335-2-45:2002

2004/108/EU

- EN 55014-1:2006
- EN 61000-3-2:2006
- EN 61000-3-3:1995 + A1:2001 + A2:2005

: 11

, 01.07.2011

# 2

TUBE

	230 , 50
	1500
MAX	400 /
	700° ,
	Ø32
	334 , Ø95
	3
	1,20

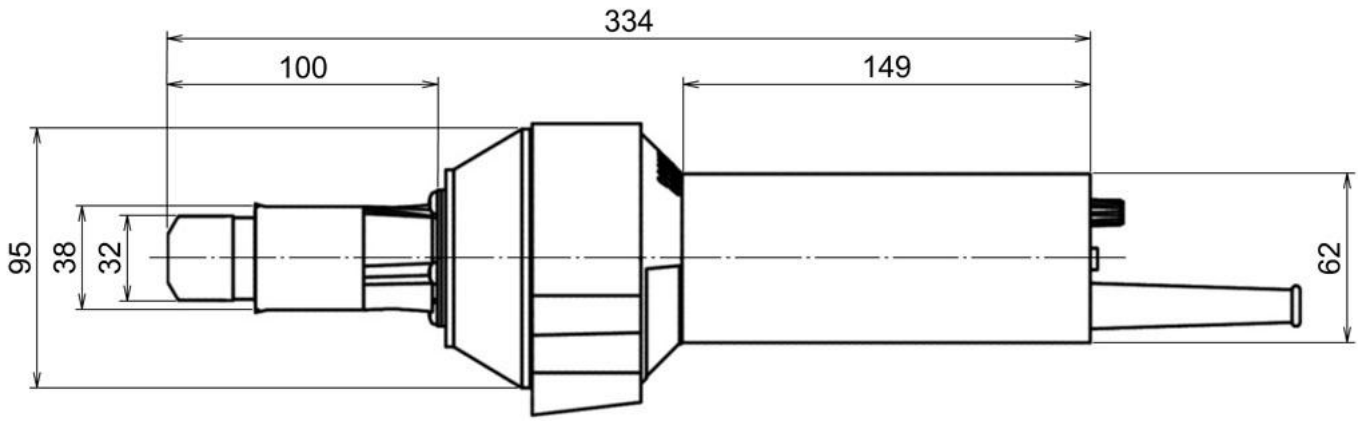

.1

TUBE-Quick

TUBE-Quick

- 
- 
- 
-

**3**

**3.1**

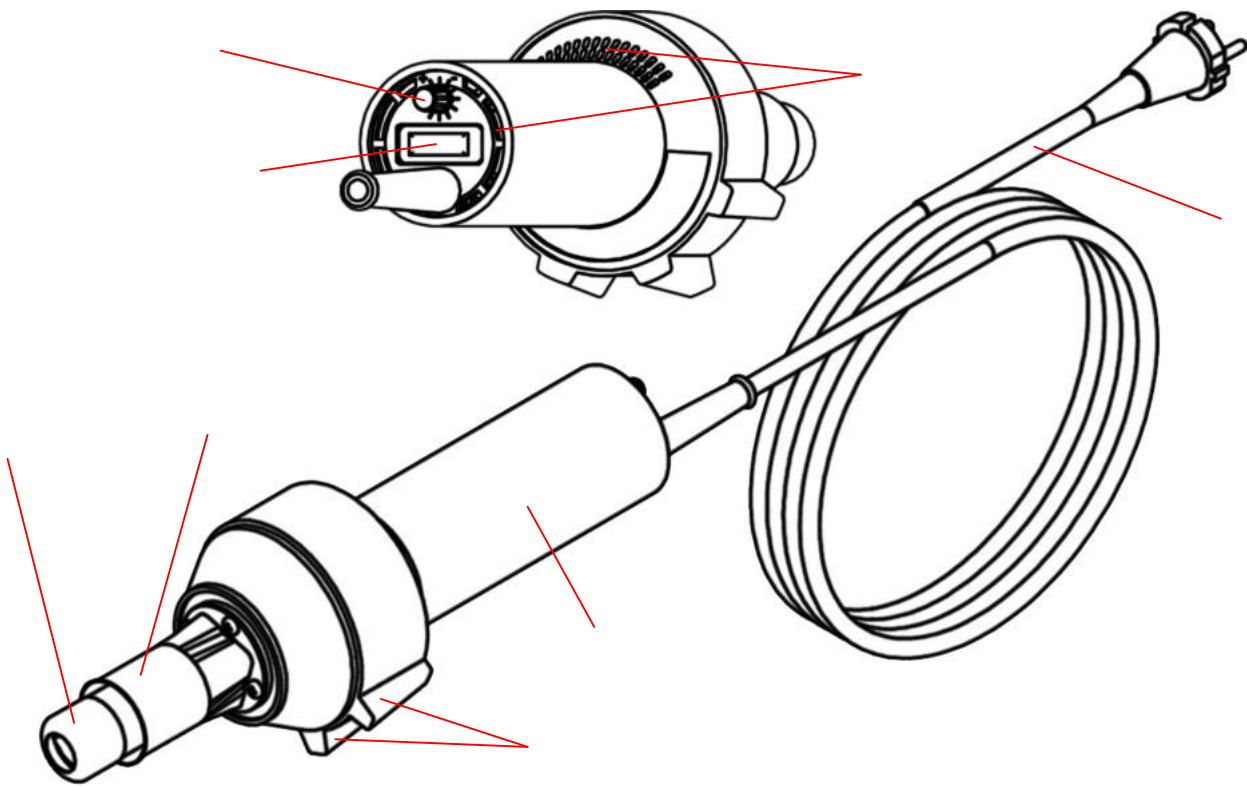

. 2

TUBE-Quick

( □ ),

( □ )

32

32

2

( □ )



3.2

4

I.

.3.4).

3.3

3.4

700°

5

1.

		Ø3	Ø4	°
PE-HD – ( )		6-10	15-20	300-350
		10-16	25-35	
PE-LD – ( )	*			260-320
PP – ( )		6-10	15-20	280-330
		10-16	25-35	
PVC-U – ( )		5-9	8-12	320-370
		8-12	15-25	
PVC-P – ( )	*			300-370
		4-8	7-12	
PVC-C – ( )		10-15	15-20	350-400
		15-20	20-25	
PMMA – ( )**		5-8	12-16	320-370
		12-16	20-30	
PVDF – ( )		10-15	15-20	350-400
		12-17	25-35	

\*)

\*\*)

# 4

## 4.1

1500

FORSTHOFF

## 4.2

4



FORSTHOFF, 230 1 500 ( . F2007).

FORSTHOFF.

# 5

1.

12

2.

3.

3.1.

FORSTHOFF  
FORSTHOFF.

3.2.

3.3.

6

3.4.

4.

5.

5.1.

.3.1.,

5.2.

5.3.

5.4.

5.5.

5.6.

5.7.

6.

7.

.1.